

LEGENDA:
 ■ EXISTENTE A= 592,05m²
 ■ DEMOLICAO A= 35,75m²

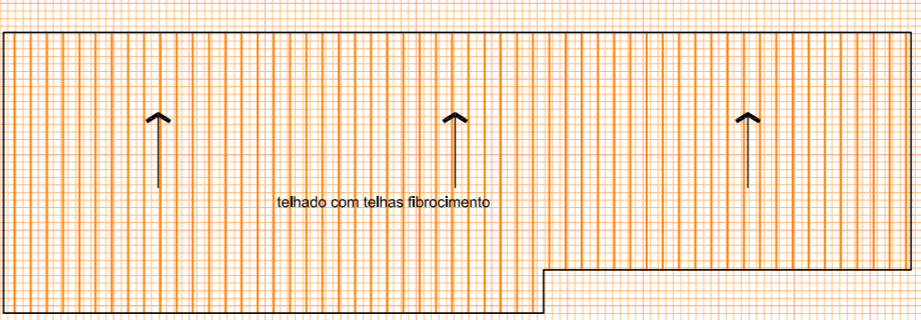
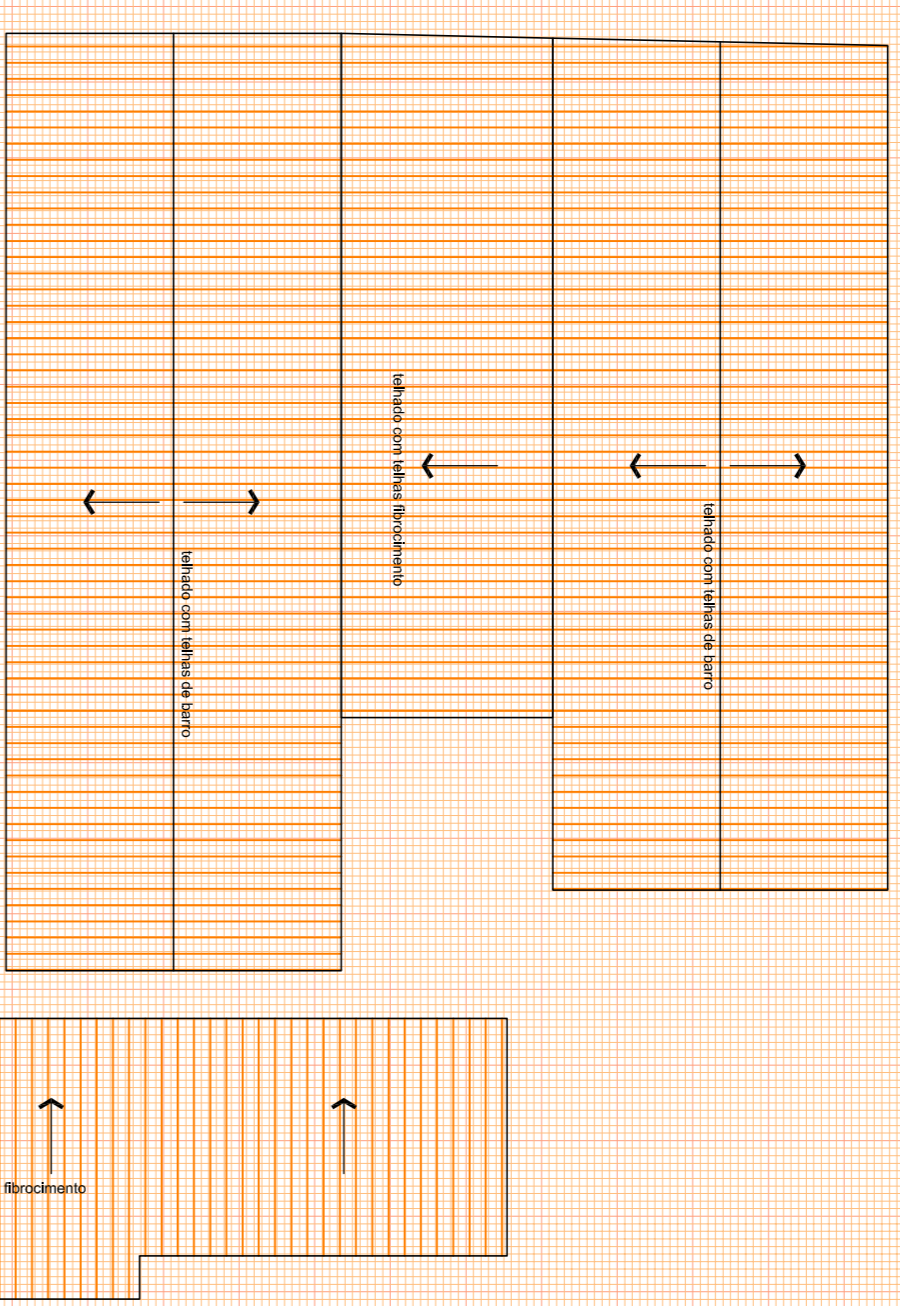
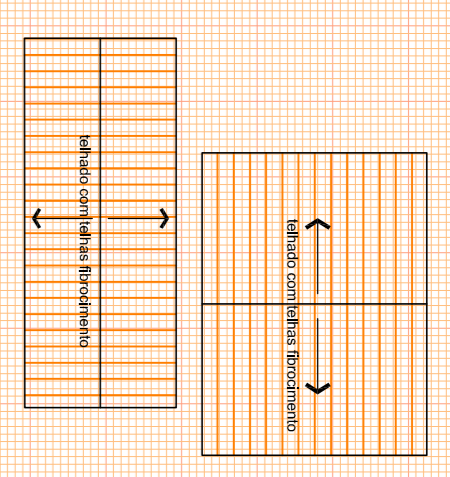
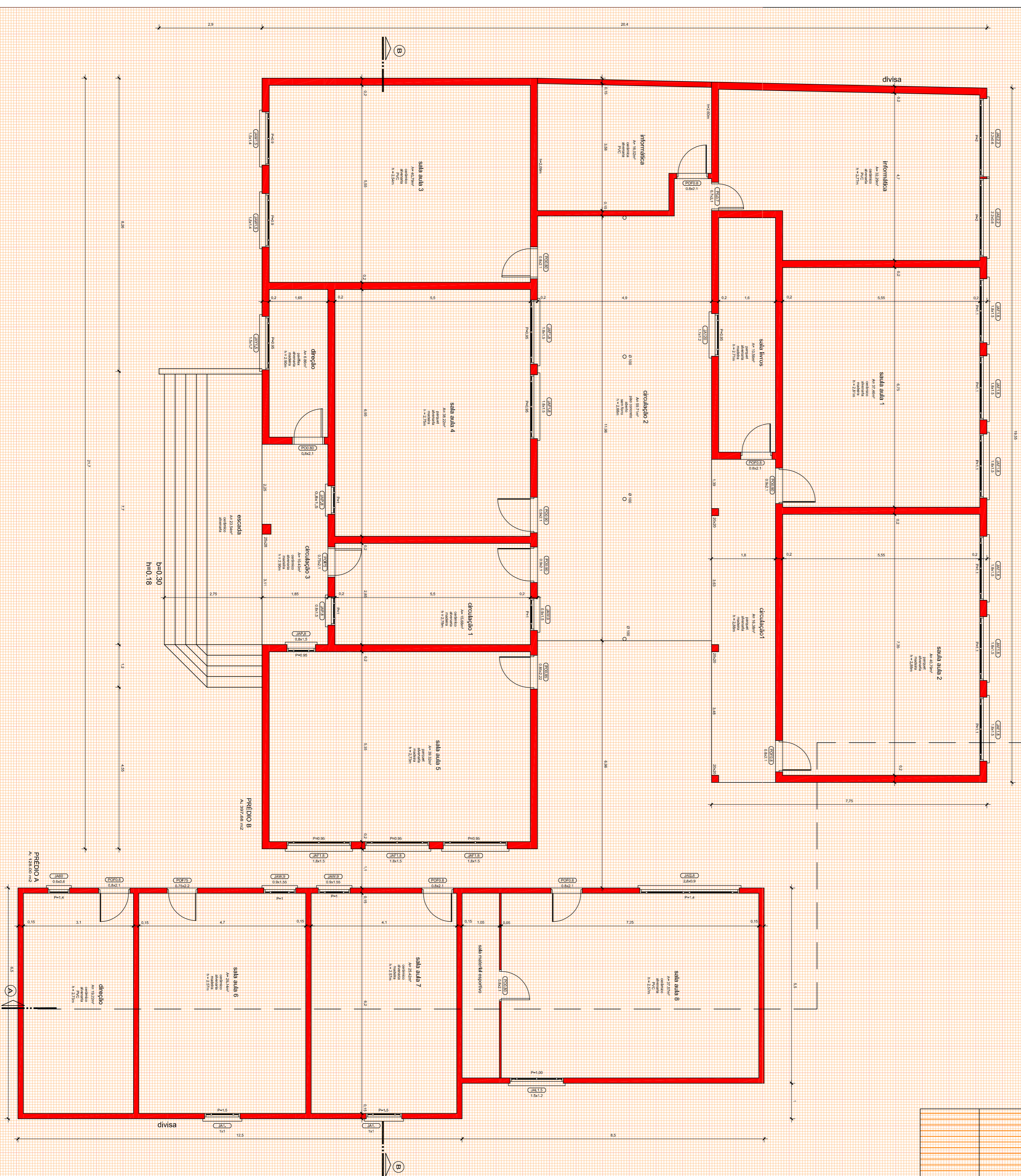
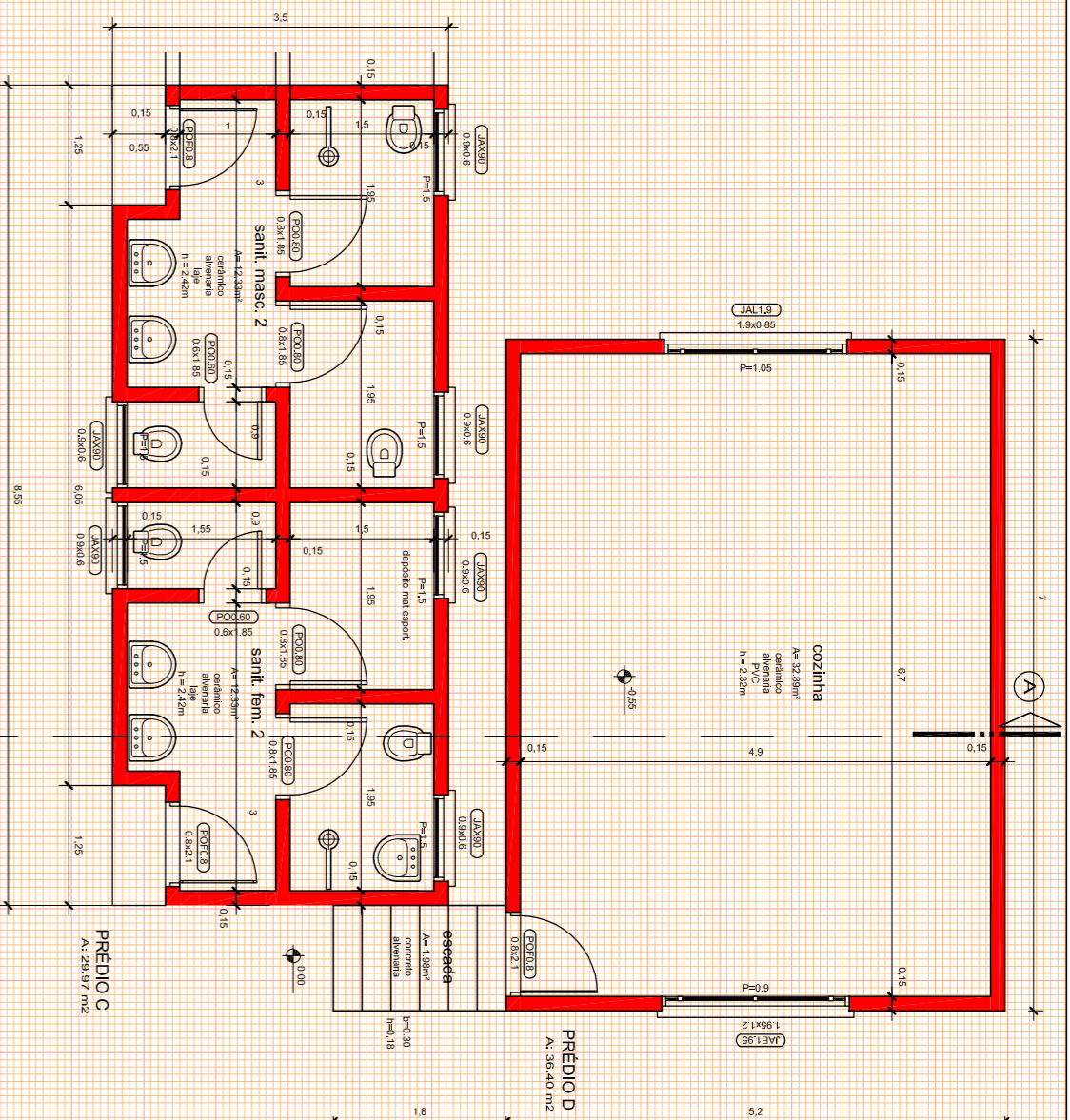
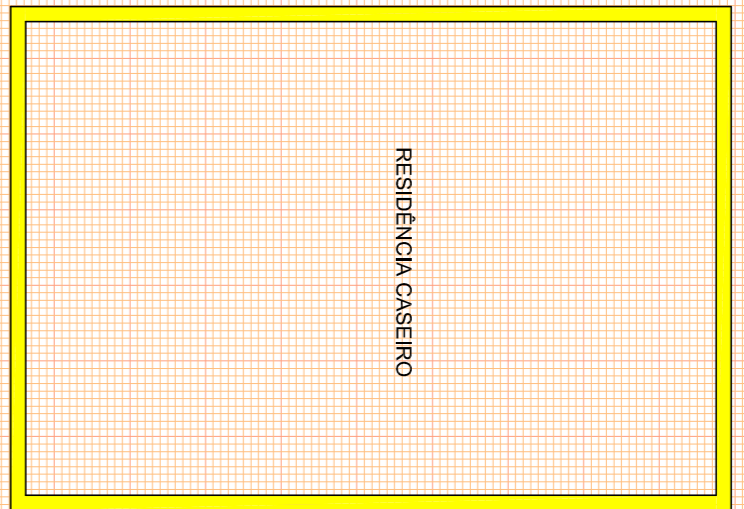

COBERTURA
1/175

SECRETARIA DE MUNICIPIO DE
DESENVOLVIMENTO URBANO
SMDUSEP
SUPERINTENDENCIA DE
ELABORACAO DE PROJETOS

PREFEITO MUNICIPAL: CEZAR SCHRIER
SECRETARIO: JULIO SILVA NETO
RUA VENANCO ABES 2277 - 5º ANDAR - CENTRO
CEP 97010-005 - SANTA MARIA - RS
(51) 3021-7088 - sed@smm.ma.rs.gov.br

PREFEITURA MUNICIPAL
DE SANTA MARIA

OBRA: **EMEF LIDOVINO FANTON**
Rua Santa Barbara, s/n., Vila Bela União, Bairro Calamba

LOCAL: **Cidade Santa Maria/RS**

TITULO: **7.1.1 - LEVANTAMENTO ARQUITETONICO ATUALIZADO**

ASSUNTO: **PLANTA BAIXA - COBERTURA**

PROPRIETARIO: _____ PROJETO: _____

MUNICIPIO SANTA MARIA

ENGENHEIRO CIVIL - CREFARS 48.489-D

ELDON ALBERTO RECKZIEGL

PROJETO: _____

PROJETADE: _____

ART. Nº: 8300757

DESENHO: CLAUDIA RECKZIEGL

DATA: DEZ/2015

FRANCHA: 02/03

AREA: 592,05m²

PLANTA BAIXA
1/175